



Livermore-Pleasanton Fire Department

3560 Nevada Street, Pleasanton, CA 94566 * 925-454-2361

FIRE TRUCK SPECIFICATION FOR FIRE APPARATUS ACCESS

The Fire Department has adopted California [Fire Code Appendix D – Fire Apparatus Access Roads](#).

Minimum unobstructed road width for straight roads is 20 feet. Curves and turns must accommodate the fire apparatus with the largest turning radius. See Figure 1. for detailed requirements.

Dead-end fire access roads/path over 150 feet in length must be provided with an approved turnaround. See Figure 2 for diagrams of acceptable turnarounds. Other designs will be considered on a case-by-case basis.

Buildings over 30 feet tall require truck aerial ladder access areas. These areas must be a minimum of 26 feet wide and must be at least 61 feet long. Their locations will be determined on a case-by-case basis during the planning process. The maximum and minimum distances of the truck from the building are determined on a case-by-case basis, based on the type and height of the building and the topography of the site. Hydrant Maintenance Identification.

FIRE TRUCK – Figure 1

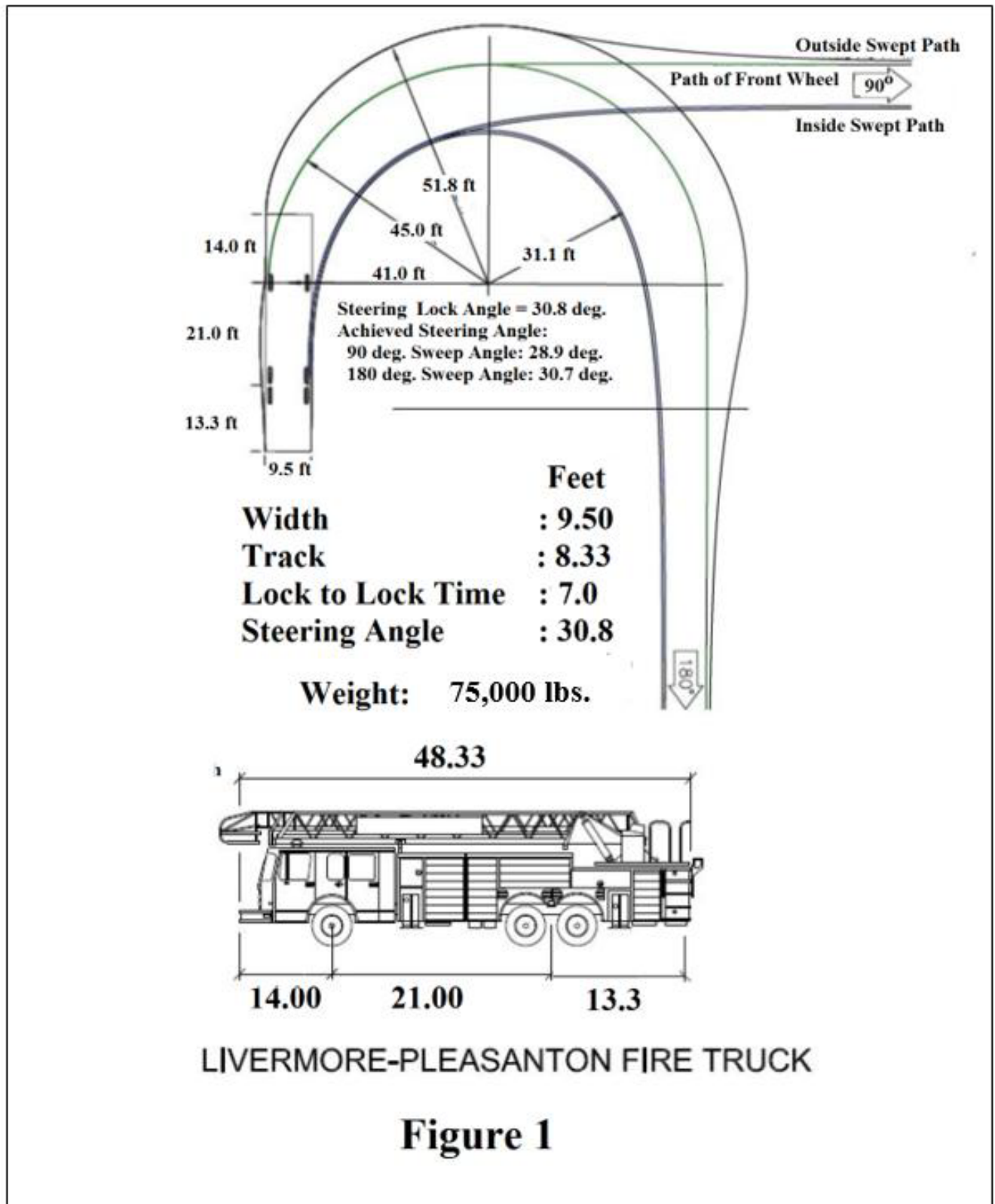

FIRE APPARATUS TURN-AROUND – Figure 2

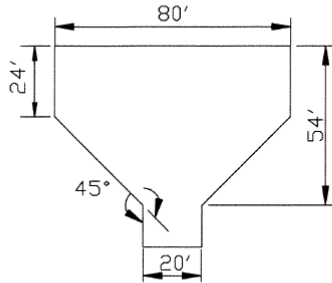

"T" HAMMERHEAD
(CHAMFER ALTERNATIVE)

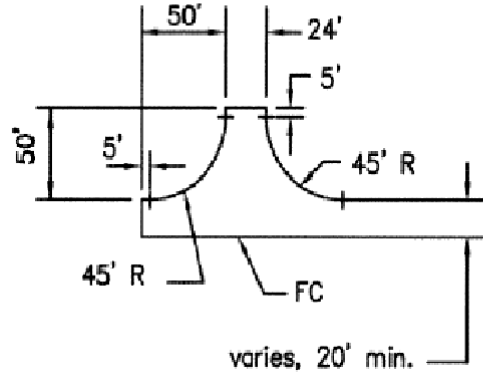

DOG LEG HAMMERHEAD

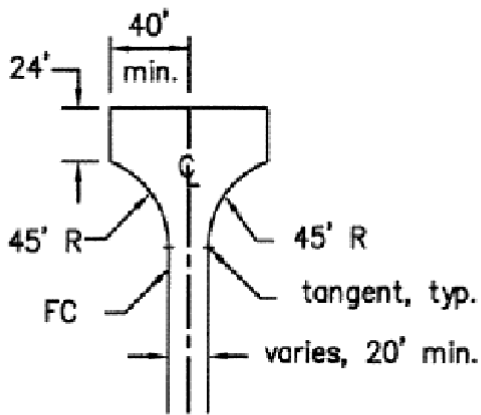

"T" HAMMERHEAD

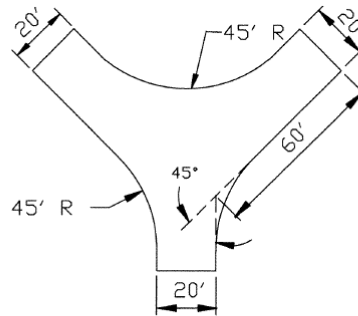

60' "Y"